

6 Gang 6A SP 2 Way Push Button Switch Traditional Plate

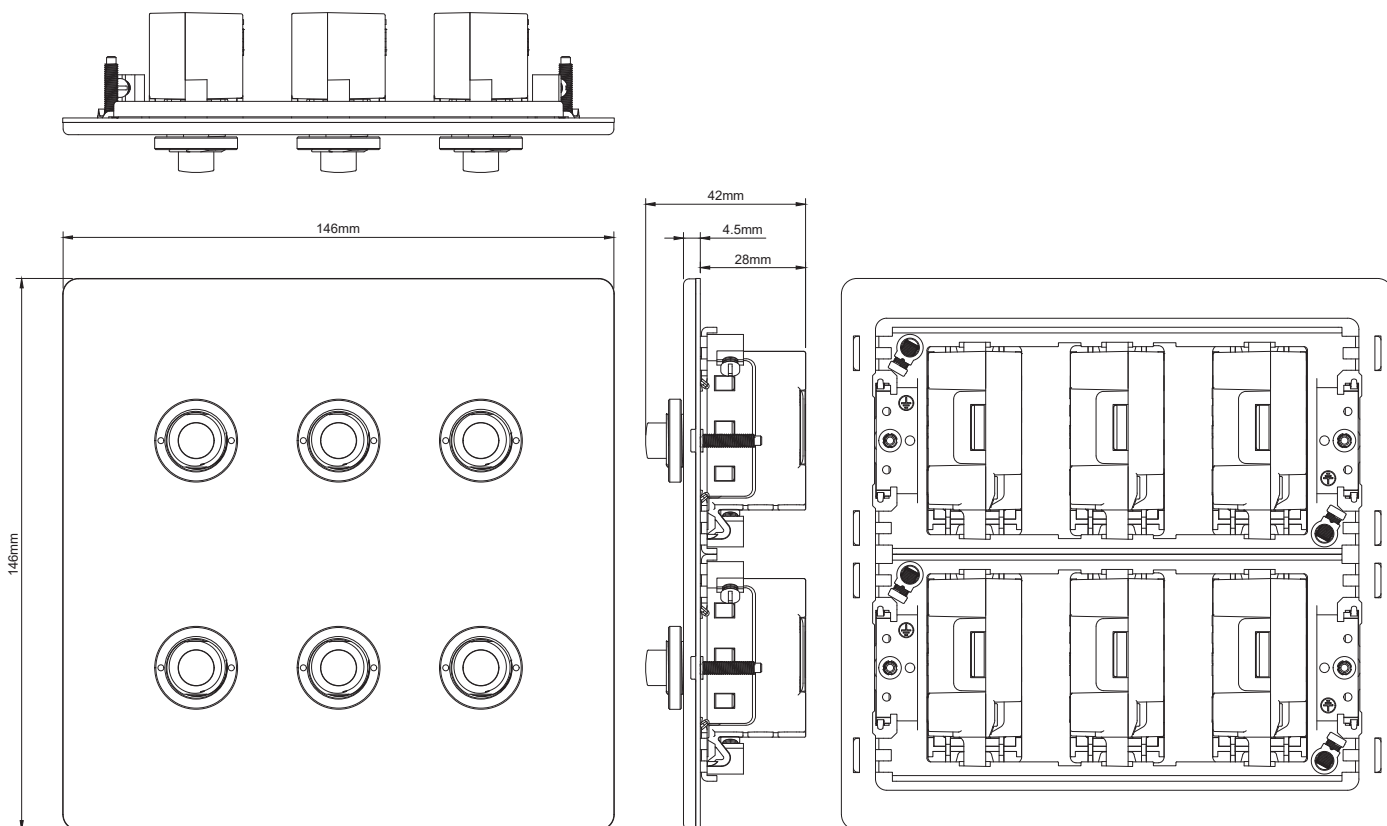

Contents

| | |
|-------------------|--|
| 20-GRD138 | 6 Gang CM Module Grid Switch Traditional Face Plate + Gasket + Frames |
| 00-SGP501 | 6A SP 2 Way Push Button CM Grid Switch Module X 6 |
| Trademarks | The Soho Lighting Company is a registered trade mark number: UK00003313349, EU017906396, Date: 25 May 2018 |

6 Gang CM Module Grid Switch Traditional Face Plate + Gasket + Frames

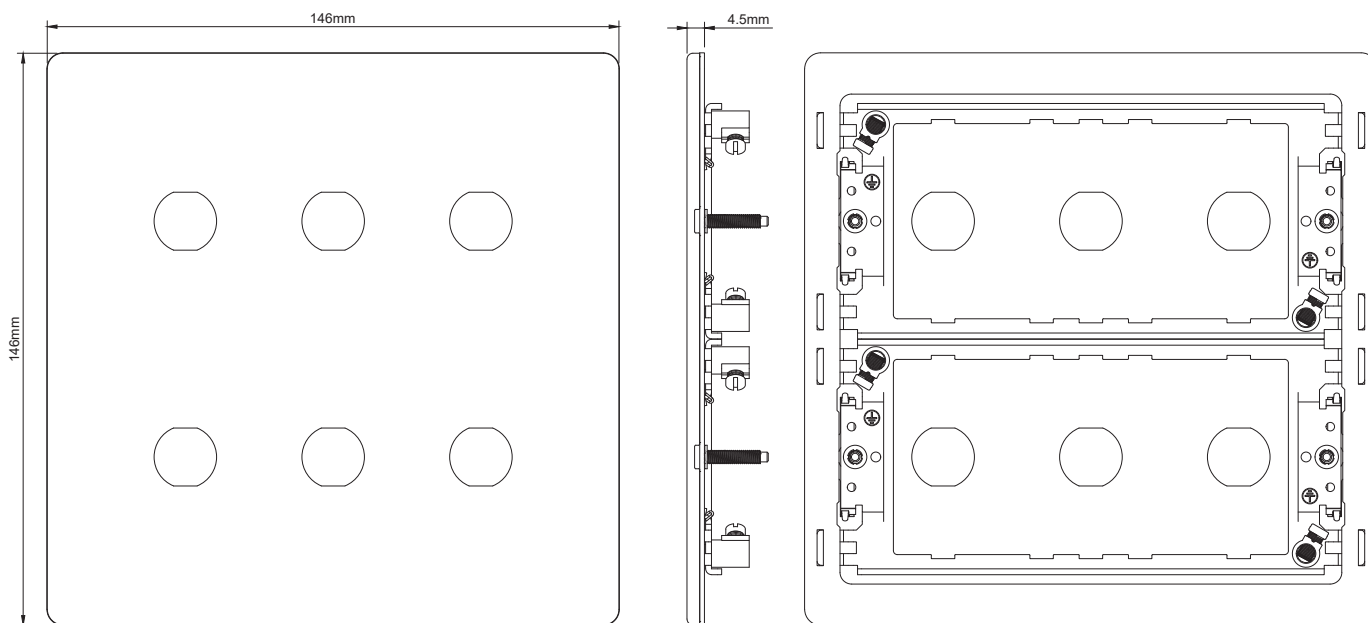

TECHNICAL SPECIFICATION

| | |
|-------------------------------|--|
| Standard(s) | BS 5733 (Where Applicable) |
| Mounting Box Depth (Min) | 35mm |
| Earth Terminal Capacity | 3 x 2.5mm ² , 2 x 4.0mm ² , 1 x 6.0mm ² (EARTH) |
| Fixing Centres | 120.6mm |
| Size | 146mm x 146mm x 4.5mm (Plate thickness) |
| Product Class 1 | Product must be earthed |
| Ambient Operating Temperature | -5° to +40°C |
| Recommended Location | Internal Use Only |
| Maximum Installation Altitude | 2000m |
| IP Rating | IP2XD |
| Trademarks | The Soho Lighting Company is a registered trade mark number: UK00003313349, EU017906396, Date: 25 May 2018 |

6A SP 2 Way Push Button CM Grid Switch Module

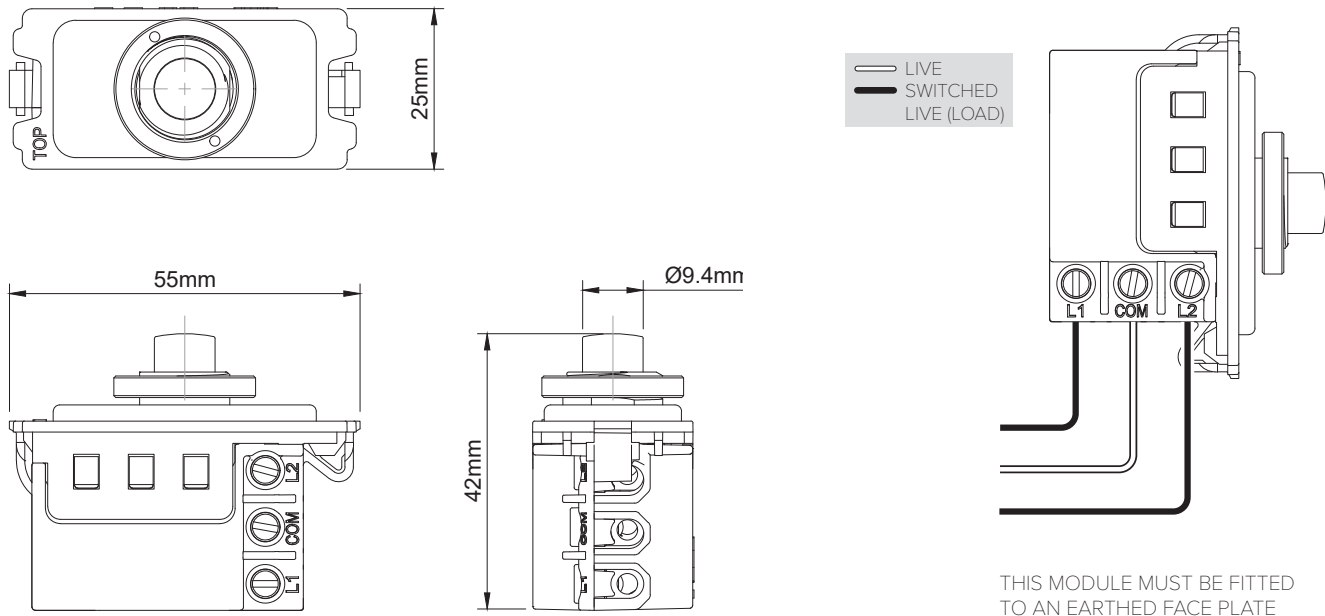

TECHNICAL SPECIFICATION

| | |
|-------------------------------|--|
| Standard(s) | BS EN 60669-1 |
| Rating | 6 Amp, 250V~ |
| Switch Type | Single Pole |
| Contact Gap | Normal Gap |
| Terminal Capacity | 3x 1.0mm ² , 2x 1.5mm ² |
| Size | 25mm x 55mm x 42mm |
| Mounting Box Depth (Min) | 35mm |
| Ambient Operating Temperature | -5° to +40°C |
| Recommended Location | Internal Use Only |
| Maximum Installation Altitude | 2000m |
| IP Rating | IP2XD |
| Trademarks | The Soho Lighting Company is a registered trade mark number: UK00003313349, EU017906396, Date: 25 May 2018 |